

Photovoltaic module, Full black, Glued with glass track (backrail) 10mm - Front glass 4mm - 48 Solar cells - Back glass 4mm
 Substructure Ventilation layer GFT 66V - Horizontal supporting profile - Glass track (backrail) for Photovoltaic module 80mm

Thermal insulation Glass wool 180mm
 Windproof membrane
 GFT Termico wall bracket - fixed point wall bracket, Cantilever 124mm, L-profil - vertical supporting profile 65/45/2.3mm

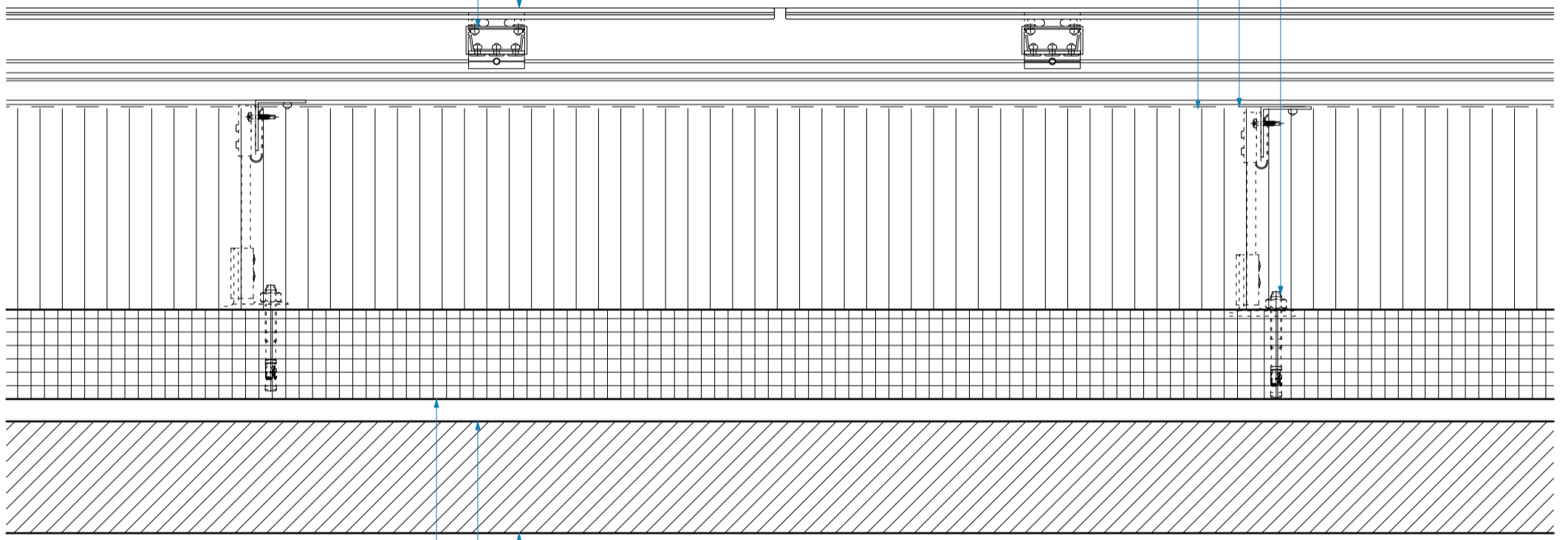

Existing, Prefabricated concrete element 80mm
 Existing, Air space or mortar layer 20mm
 Existing, Brick masonry 100mm
 Existing, Woodchip wallpaper + Plaster 10mm

Project name
Wattbuck Tower Effretikon
 Plan name
Horizontal Section
 Source of detail
Arento AG-Nachhaltige Architektur
 Scale
A3 - 1:5 0 5 10 20
 Redrawn by
BUK-ETHZ Date of creation
29.01.2021