

- PV-Modul "Solarwall" 14mm
- Kleber 6mm
- Vertikales Trägersystem 50mm
- Horizontales Trägersystem 60mm
- Dämmung Mineralwolle "Saglan" 60mm
- Dämmung Mineralwolle "Saglan" 100mm
- Dämmung Mineralwolle "Saglan" 100mm
- Alba Vollgipsplatte 80mm

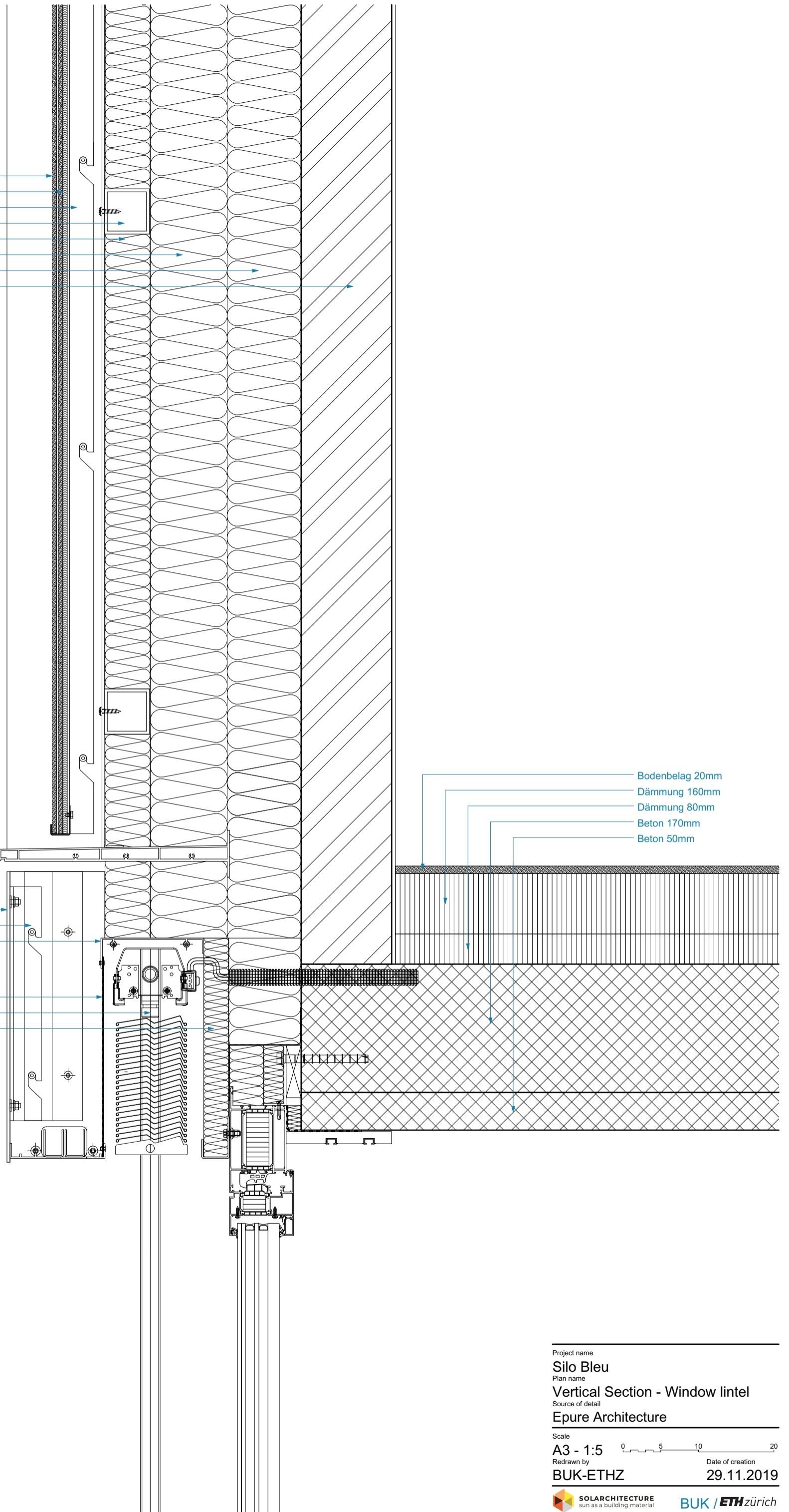

- Fensterbrett Aluminiumprofil
- Aluminiumblende 4mm
- Unterkonstruktion
- Obere Kastenabdeckung
- Perforiertes Aluminiumblech 2mm
- Motorisierter Lamellenstoren
- Dämmung Mineralwolle "Saglan" 40mm

- Bodenbelag 20mm
- Dämmung 160mm
- Dämmung 80mm
- Beton 170mm
- Beton 50mm

Project name  
**Silo Bleu**

Plan name  
**Vertical Section - Window lintel**

Source of detail  
**Epure Architecture**

---

Scale  
**A3 - 1:5**

Redrawn by  
**BUK-ETHZ**

Date of creation  
**29.11.2019**

 sun as a building material

