

- PV-Module "Solarwall" 14mm
- Glue 6mm
- Vertical substructure 50mm
- Horizontal substructure 60mm
- Insulation mineral wool "Saglan" 60mm
- Insulation mineral wool "Saglan" 100mm
- Insulation mineral wool "Saglan" 100mm
- Plasterboard "Alba" 80mm

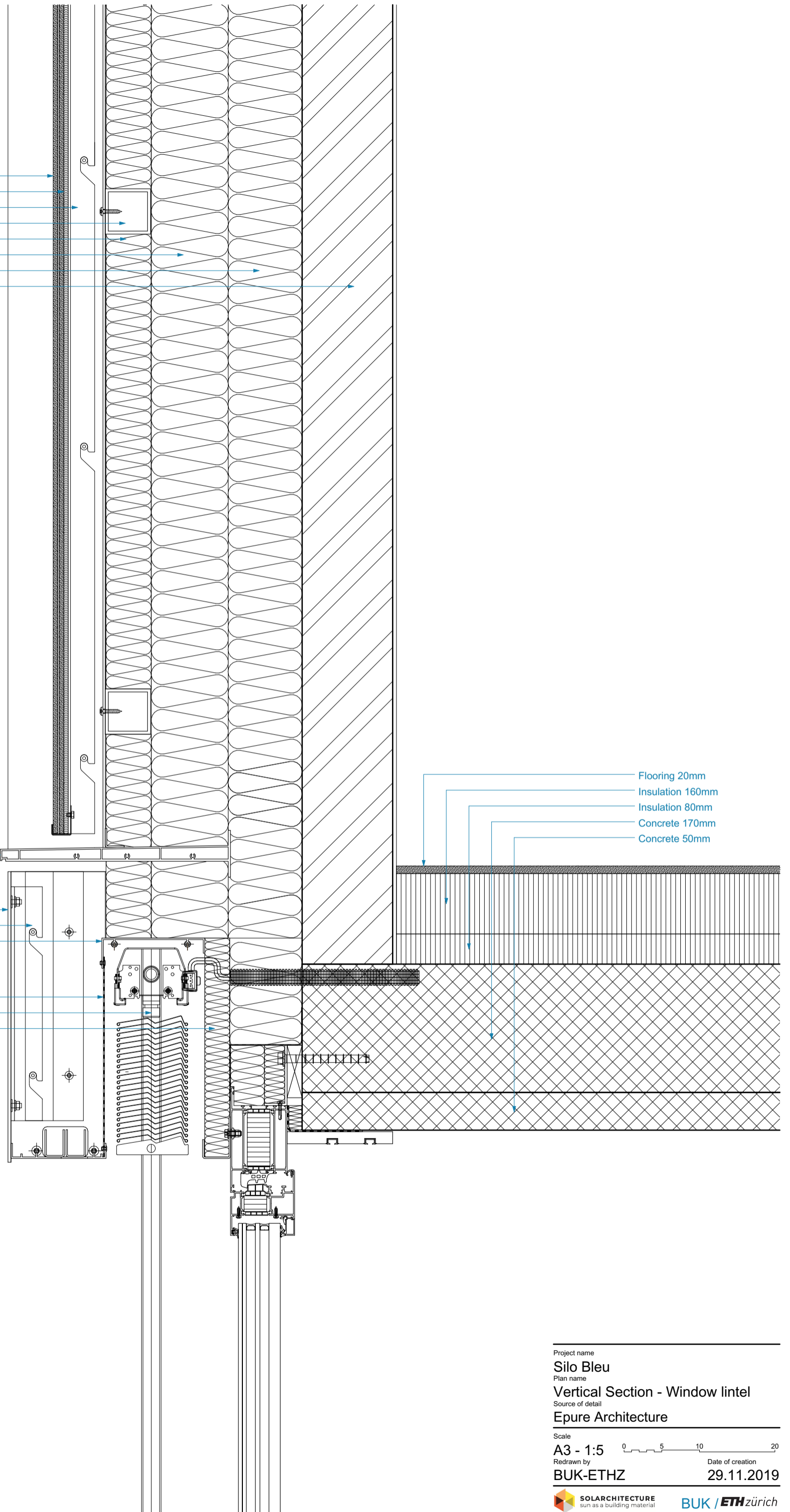

- Window sill aluminium profile
- Aluminium cover 4mm
- Substructure
- Covering
- Perforated Aluminium sheet 2mm
- Motorized roller shutter
- Insulation mineral wool "Saglan" 40mm

- Flooring 20mm
- Insulation 160mm
- Insulation 80mm
- Concrete 170mm
- Concrete 50mm

Project name
Silo Bleu
 Plan name
Vertical Section - Window lintel
 Source of detail
Epure Architecture

Scale
A3 - 1:5 0 5 10 20

Redrawn by
BUK-ETHZ Date of creation
29.11.2019